

TOWN OF SPRINGERVILLE INCORPORATED BOUNDARIES

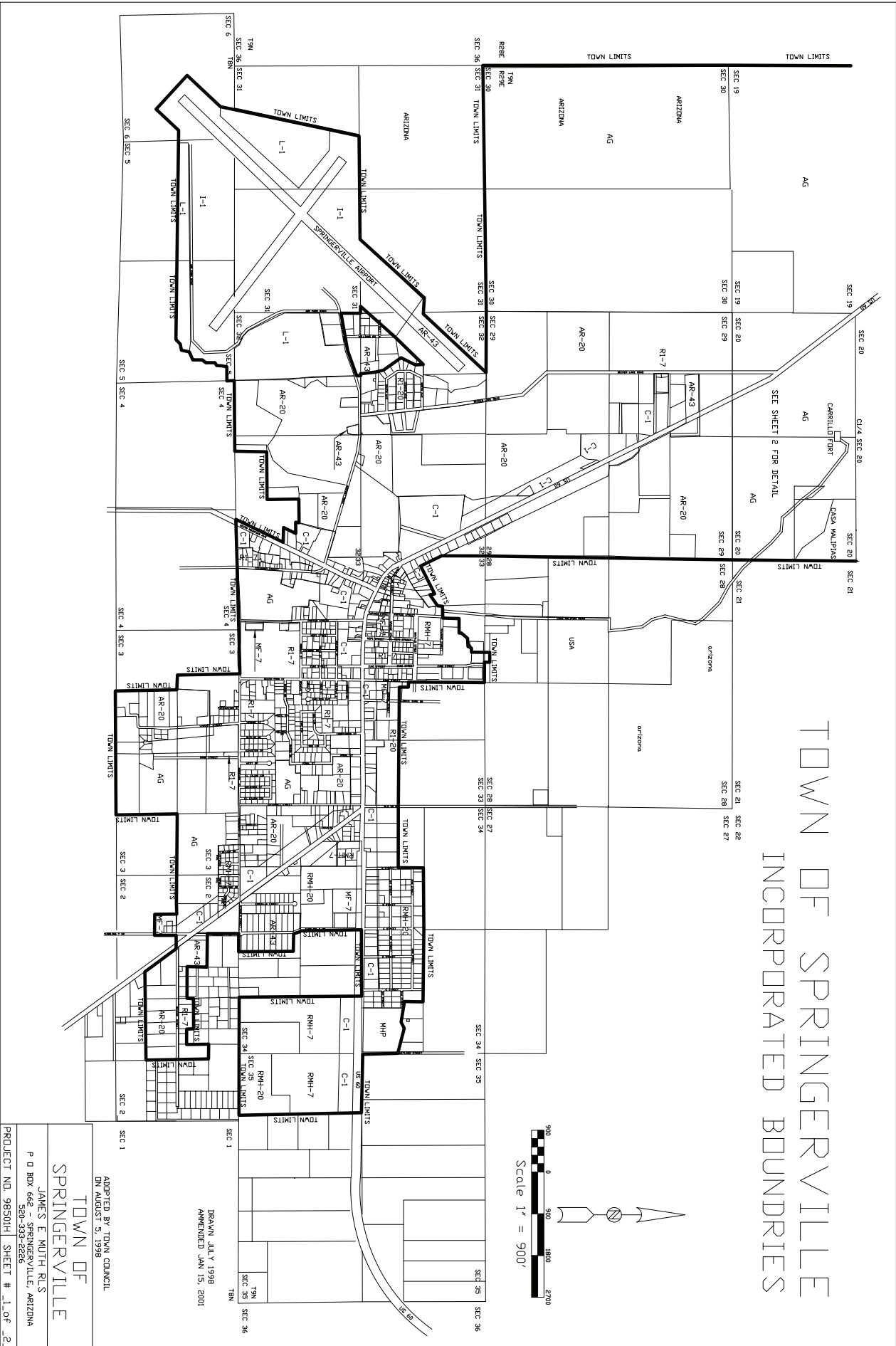

TOWN OF
 SPRINGERVILLE
 JAMES E. MUTH, RLS
 P O BOX 662 - SPRINGERVILLE, ARIZONA
 520-333-2226
 PROJECT NO. 98501H SHEET # 1 of 2

ADOPTED BY TOWN COUNCIL
 ON AUGUST 5, 1998
 DRAWN JULY 1998
 AMENDED JAN 15, 2001